

PD921V VERTICAL TYPE SERIES EXIT DEVICE-REVERSIBLE

INSTALLATION INSTRUCTIONS

LHR door shown, RHR door opposite

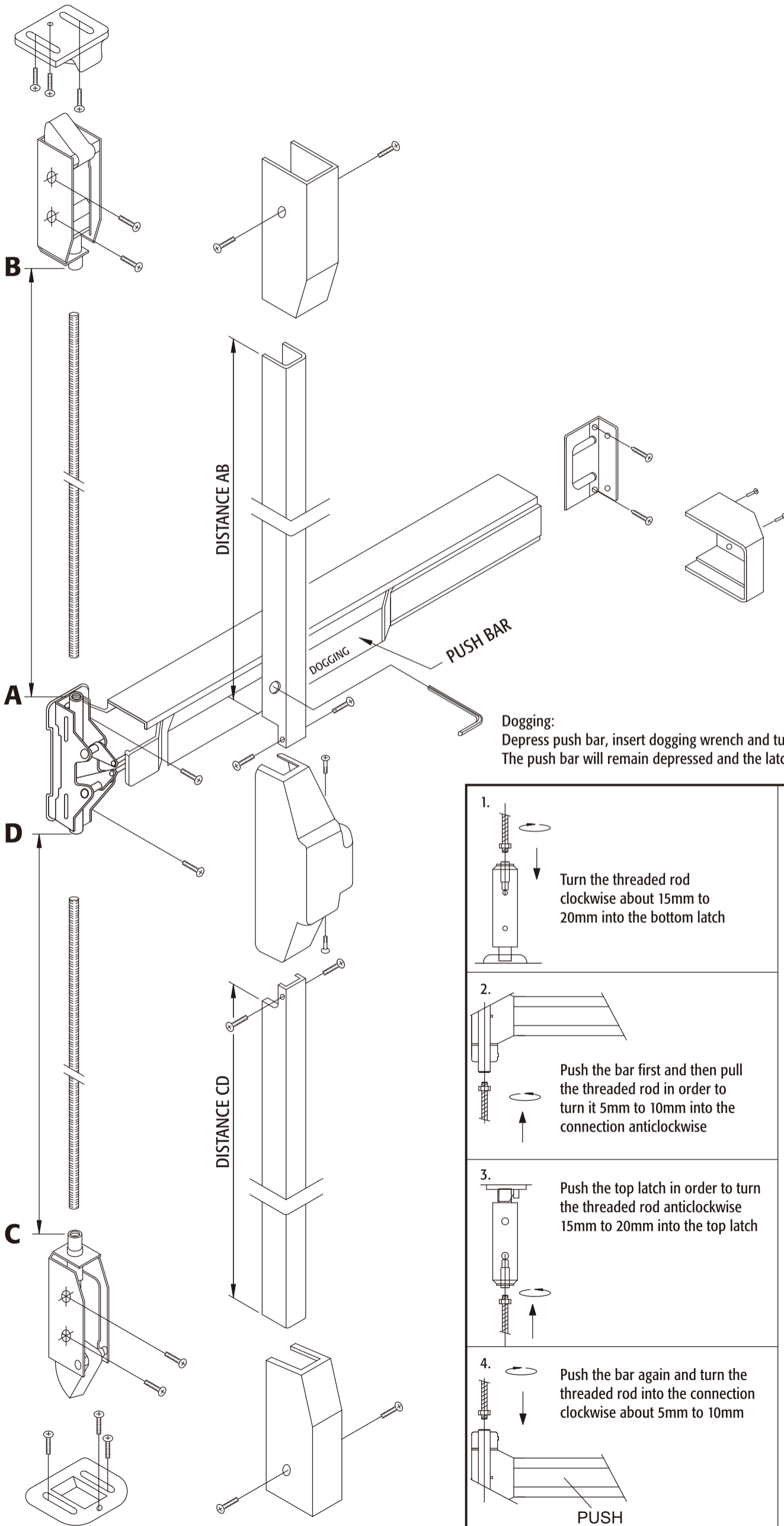

<p>1.</p> <p>Turn the threaded rod clockwise about 15mm to 20mm into the bottom latch</p>	<p>A : Top strike and shims (if necessary). B : Top latch. C : Head assembly. D : Bottom latch. E : Bottom strike and strike shims (if necessary). F : End plate. G : Nuts</p>
<p>2.</p> <p>Push the bar first and then pull the threaded rod in order to turn it 5mm to 10mm into the connection anticlockwise</p>	
<p>3.</p> <p>Push the top latch in order to turn the threaded rod anticlockwise 15mm to 20mm into the top latch</p>	
<p>4.</p> <p>Push the bar again and turn the threaded rod into the connection clockwise about 5mm to 10mm</p> <p>PUSH</p>	
<p>5. Test the movement, and then tighten the nut, put on all the other parts.</p>	

