

Timing of Double Cylinder Classroom Security Function

A. OUTSIDE

1. With the lock installed on door, using a philips head screwdriver to rotate "Figure 8" hole of key cam in outside spindle clockwise (CW) to the end .

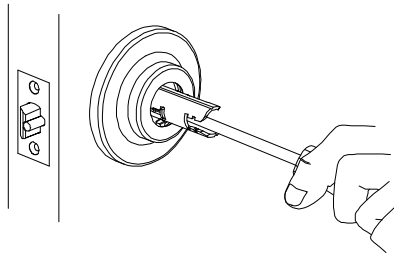
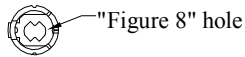

2. Then, to rotate back 180° for "Figure 8" hole of key cam to be in horizontal position. (∞)

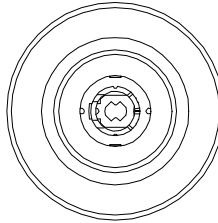

- 3.1 Installing IC core

- a. Insert lever onto spindle.
- b. With control key in core rotate 15° clockwise and insert fully into lever.
- c. Turn the key counter clockwise and remove key.
- d. Check function before closing door.**

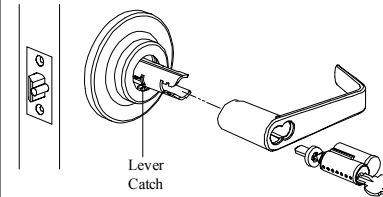

- 3.2 Installing standard cylinders & lever

- a. Align hole in lever with lever catch on spindle assembly and slide lever up to lever catch.
- b. For outside lever only: Turn key 90° clockwise and hold.
- c. Push lever in to engage lever catch.
- d. Check function before closing door.**

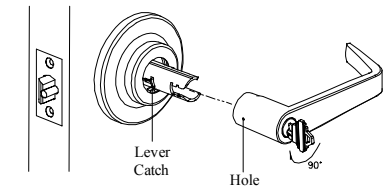

B. INSIDE

1. Also with the lock installed on door, using a philips head screwdriver to rotate "cross-hole" of key cam in inside spindle counter clockwise (CCW) to the end.

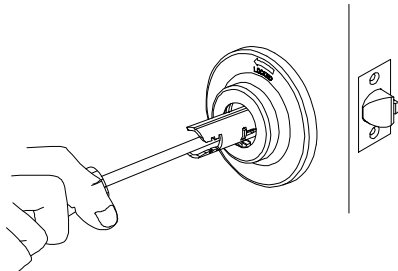
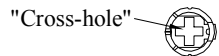

2. Then, to rotate back 180° for the "cross-hole" of key cam to be in upright position. (⊕)

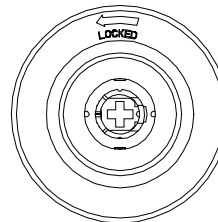

- 3.1 Installing IC core

- a. Insert lever onto spindle.
- b. With control key in core rotate 15° clockwise and insert fully into lever.
- c. Turn the key counter clockwise and remove key.
- d. Check function before closing door.**

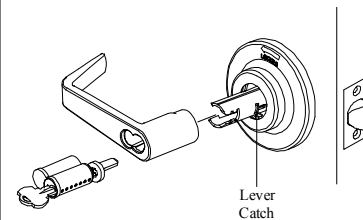

- 3.2 Installing standard cylinders & lever

- a. Align hole in lever with lever catch on spindle assembly and slide lever up to lever catch.
- b. Push lever in to engage lever catch.
- c. Check function before closing door.**

